

IMPORTANT SAFETY PRECAUTIONS & GENERAL CARE

Mounting:

Four rope ratchets are included with each light. We recommend hanging this fixture using all four of the ratchets. Start by placing your light fixture on the floor with the LEDs facing downward. Attach the rope ratchets to each of the four mounting points on your light. Then, hang up each of the rope ratchets in the location you want to hang your light in and raise to desired hanging height. This is an aluminum, passively cooled LED fixture. The top of the fixture must be unobstructed to properly radiate heat away from the LEDs. Leave a minimum 10 inch air gap above the fixture for proper passive ventilation.

First time LED growers:

If this is your first LED grow light, congratulations & thank you for supporting Chilled Tech. LED fixtures of this caliber are very intense. We recommend you start by hanging the fixture as high as your space allows on day one. Using a power monitor, dim the fixture by 50%. New growth of your plant will likely be a lighter lime green color that will settle into a darker green color, this is from internode stacking. If your growth stays lighter lime green, or looks washed out, this is likely a result of too much light. Start high & slow and let your plants adjust to the intensity over the course of one week. Taking these steps early on will save you time in the long run.

Cleaning:

Isopropyl Alcohol / Rubbing Alcohol dabbed onto a microfiber cloth is a great way to clean any gunk off of your light fixture and LEDs. Be careful if cleaning the LEDs, too much pressure could damage them.

Precautions:

Warning: Growcraft is a heavy duty light fixture system and might be too heavy for one person to handle alone.

We recommend at least two people move the light together when necessary.

Warning: it is important to keep in mind that Growcraft lights are not water proof. Be careful when watering your plants to ensure no water splashes and makes contact with the LEDs.

Warning: Do not disassemble the LED fixture, opening the fixture can be dangerous and it will void the warranty.

Warning: Wait at least 30 minutes for the light bars to cool down before touching the fixture.

Warning: Make sure not to rest your power supply cable on any hot surfaces and avoid coiling.



COMMERCIAL X3 500W USER MANUAL

Specifications

Input Power Draw	500W 90-305 VAC
Power Drivers:	Mean Well HLG-480H-48B
Spectrum	3000k, 5000k, 660nm mix
Dimming Range	5-100%
Light Engine Efficacy	3.26 $\mu\text{mole/J}$ – 2.73 $\mu\text{mole/J}$
Full System Efficacy	3.08 $\mu\text{mole/J}$ – 2.58 $\mu\text{mole/J}$
Thermal Management	Passive all aluminium
Minimum Head Space Above Fixture	10 in
Recommended Hanging Height	18- 30 in
Coverage Area	3 x 5 ft
Fixture Dimensions	42.5 in x 19.5 in x 1.375 in
Fixture Weight	17 Lbs
Warranty	5 Year Limited

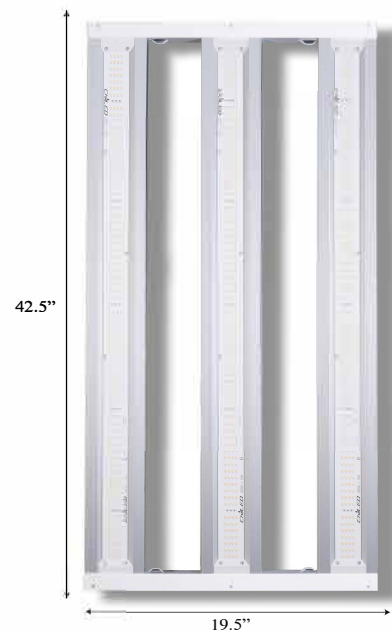

System hardware

- A. Growcraft X3 LED Fixture
- B. Push-Lock Mean Well HLG-480H-48B LED Driver
- C. Push Lock 7ft Driver Extension Cable
- D. Push Lock AC Power Cord (Your Choice of AC Plug)
- E. Push-Lock Dimmer Pot
- F. 2 x 3/16in Rope Ratchet – Metal Mechanism – 2 Pack

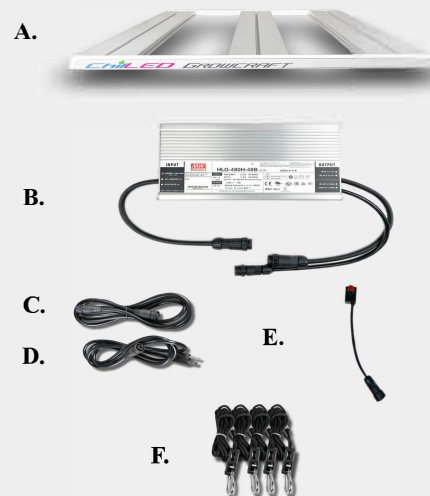

Mouting | Installation

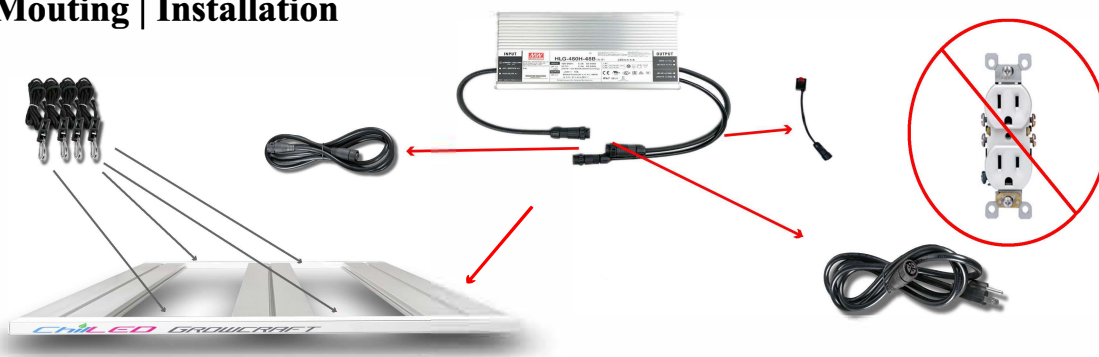

WARNING:

Never plug into wall before all other connections are made.

Connecting or disconnecting The DC extension while energized could permanently damage your fixture & void warranty.